



## **Design Detail**

### **DD 1910-04**

Techwood 4400 Treated Lumber in  
Load Bearing, Exterior Walls in Type III  
Construction

**Chemical Technologies  
Holding, Inc.**

### **Product:**

**Techwood 4400 (TW4400)**

Issue Date:

October 14, 2019

Revision Date:

September 8, 2022



COMPANY  
INFORMATION:

Chemical Technologies  
Holding, Inc.  
205 Biscayne Blvd Ste 4-629  
Aventura, FL 33180-1529  
(786) 471-2133

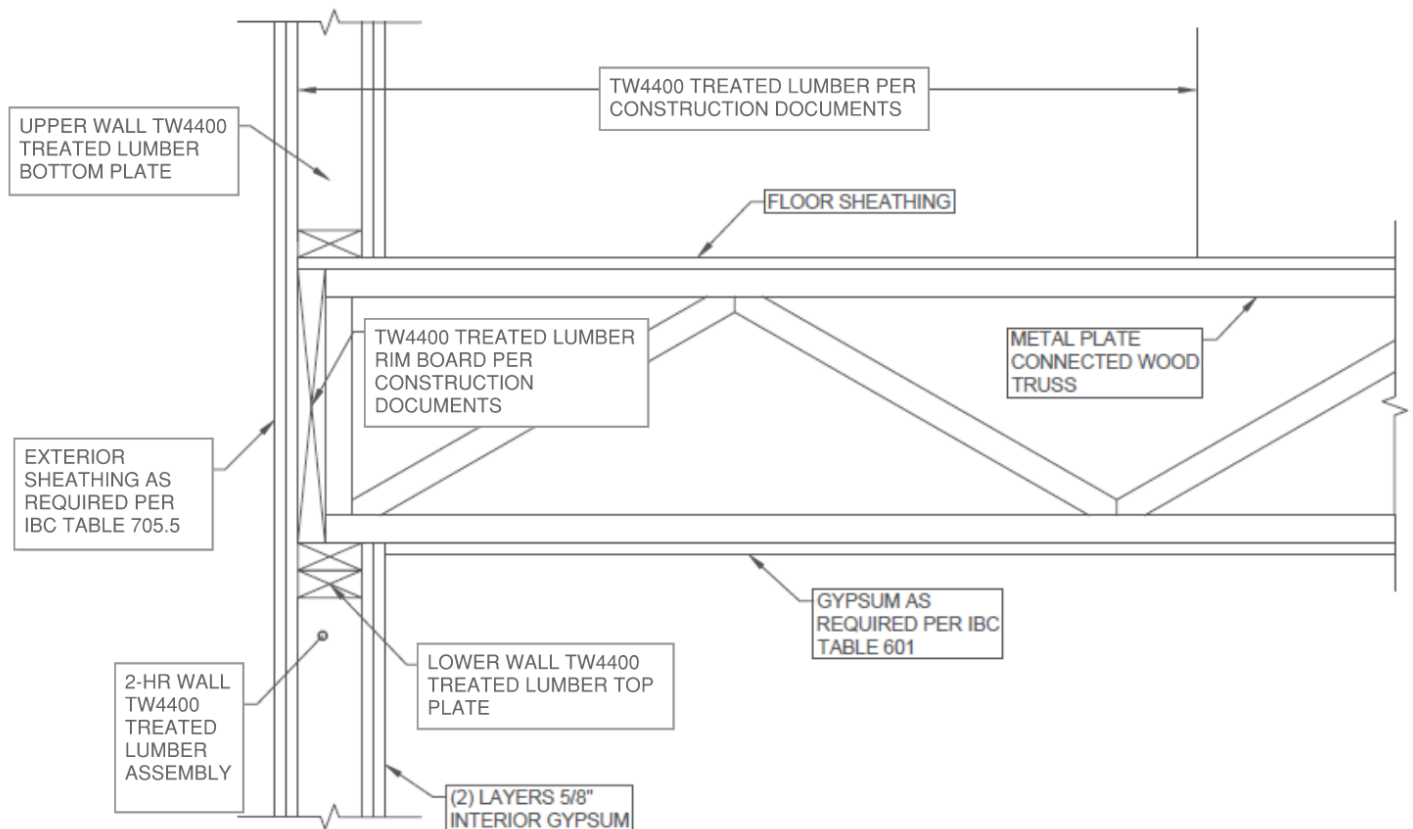

Figure 1. Truss End with Rim Board Detail for Type III Exterior Walls where Truss Ends are treated with TW4400

## 1 Notes

- 1.1 This is an above code detail showing the use of TW4400 in the floor cavity at load bearing, exterior walls in Type III construction. Exterior cladding and other materials exterior of the exterior sheathing not shown for clarity.
- 1.2 The seal on this design drawing indicates acceptance of professional engineering responsibility solely for the component(s) depicted. The design assumptions, loading conditions, suitability, and use of this component for any particular building is the responsibility of the building designer or owner of the components, per *TPI 1*. The responsibilities and duties of the component design engineer and component manufacturer shall be in accordance with the latest edition of *TPI 1* Chapter 2 unless otherwise defined by a contract agreed upon by the parties involved.