

Design Detail

Report No: DD 1910-04



Issue Date: October 14, 2019

Revision Date: April 9, 2026

Techwood 4400 Treated Lumber in Load Bearing, Exterior Wall in Type III Construction

Product: Techwood 4400 (TW4400)

Trade Secret Report Holder:

Chemical Technologies Holding, Inc.

Address: 20533 Biscayne Blvd Ste 4-629
Aventura, FL 33180-1529

Phone: 858-780-4747

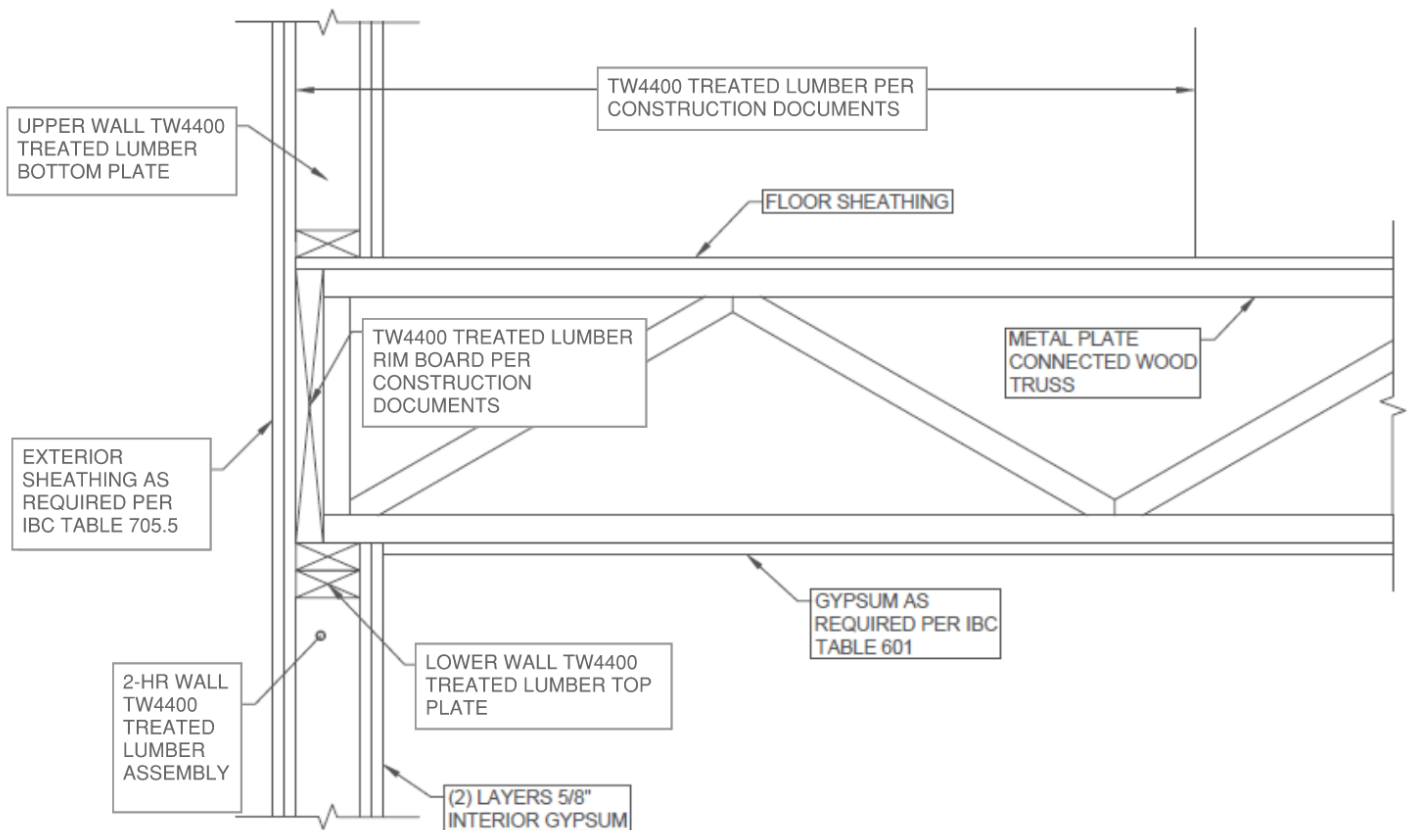

Figure 1. Truss End with Rim Board Detail for Type III Exterior Walls where Truss Ends are treated with TW4400.



1 Notes

- 1.1 Figure 1 is a code-approved detail showing the use of TW4400 in the floor cavity at load bearing, exterior walls in Type III construction. Exterior cladding and other materials exterior of the exterior sheathing not shown for clarity.
- 1.2 The seal on this design drawing indicates acceptance of professional engineering responsibility solely for the component(s) depicted. The design assumptions, loading conditions, suitability, and use of this component for any particular building is the responsibility of the building designer or owner of the components, per TPI 1. The responsibilities and duties of the component design engineer and component manufacturer shall be in accordance with the latest edition of TPI 1 Chapter 2 unless otherwise defined by a contract agreed upon by the parties involved.